



Sanaz Mazinani **Surface**

View from the 11th Street entrance of the 1500 Mission Street Atrium Lobby.



Installation view from the second floor mezzanine.

Art Proposal for the 1500 Mission St Atrium

CONCEPT

Home to the Planning Department, Building Inspection, and Public Works, the 1500 Mission Building will be a significant hub for the growth, development, and sustainability of San Francisco. These departments work tirelessly together to create a better life for the City's citizens. *Surface* explores the ways in which these departments reflect the needs of the public through a transparent generative process where ideas and actions commingle, innovate and move the city forward.

In order to express these relationships, Sanaz Mazinani will employ techniques of data visualization to create an abstract landscape of the City of San Francisco. The sculpture will be comprised of a series of 37 hanging panels formed of triangular tessellations – the triangle referencing the three main departments in the building. Each panel represents a neighborhood of San Francisco. Each nine-inch equilateral triangle represents 250 inhabitants. The size of each panel is thereby determined by the population of each neighborhood. Additionally, the panel forms reference the topographic profile and elevation of the neighborhoods they represent. Last, each panel will depict the green space in each neighborhood by means of apertures where light can shine through.

INSPIRATION

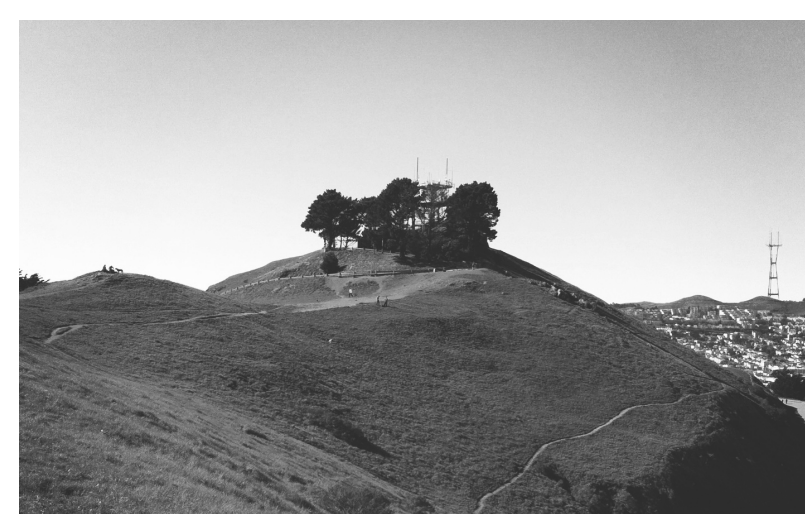

Rolling hills of San Francisco (Bernal Heights)

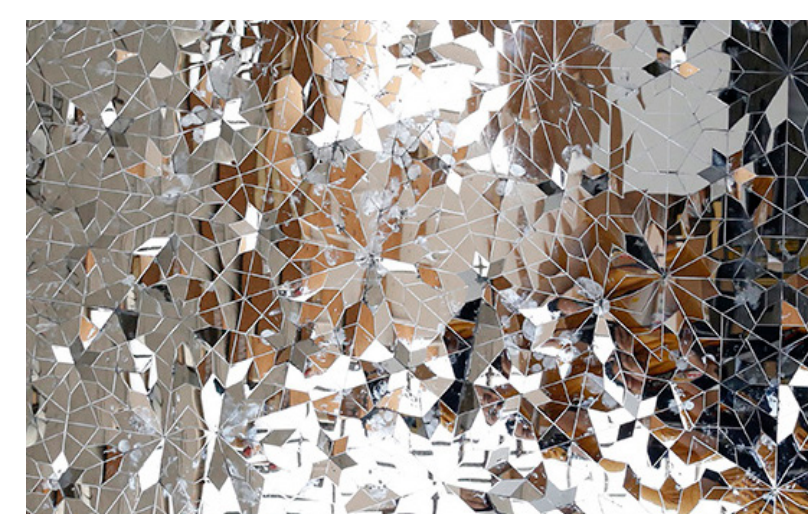

Reflections in undulating mirrored surface

Coming together in a dynamic spherical form suspended in the lobby centre *Surface* will provide unique views from the ground, second and third floors. One side of the faceted tessellations composing the undulating surface of the panels is composed of mirrored stainless steel and the opposing side is powder coated in a flat matt white finish. The visiting public contribute to the ever changing reflections of the mirrored surfaces, which echo the shifting patterns of the city. The white surfaces reflect light at different angles to create subtle variations in tone that resemble folded paper, referencing, in part, the intellectual output of the departments that build, alter and sustain the physical terrain of the city.

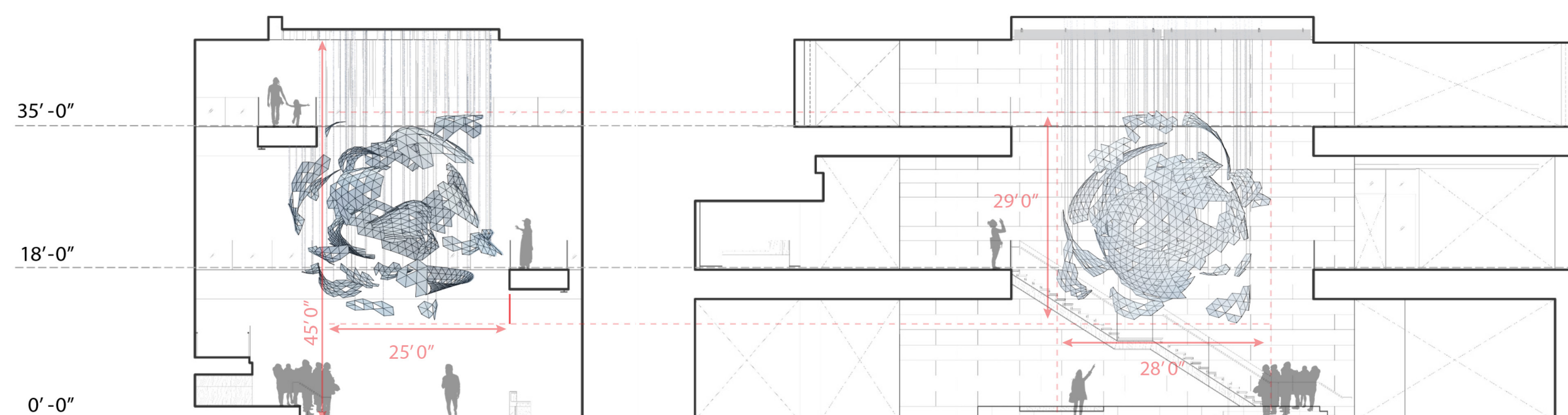

Lobby Atrium Elevation North

Lobby Atrium Elevation North Stair



Panel size is a function of neighborhood population

GEOMETRIC ABSTRACTION

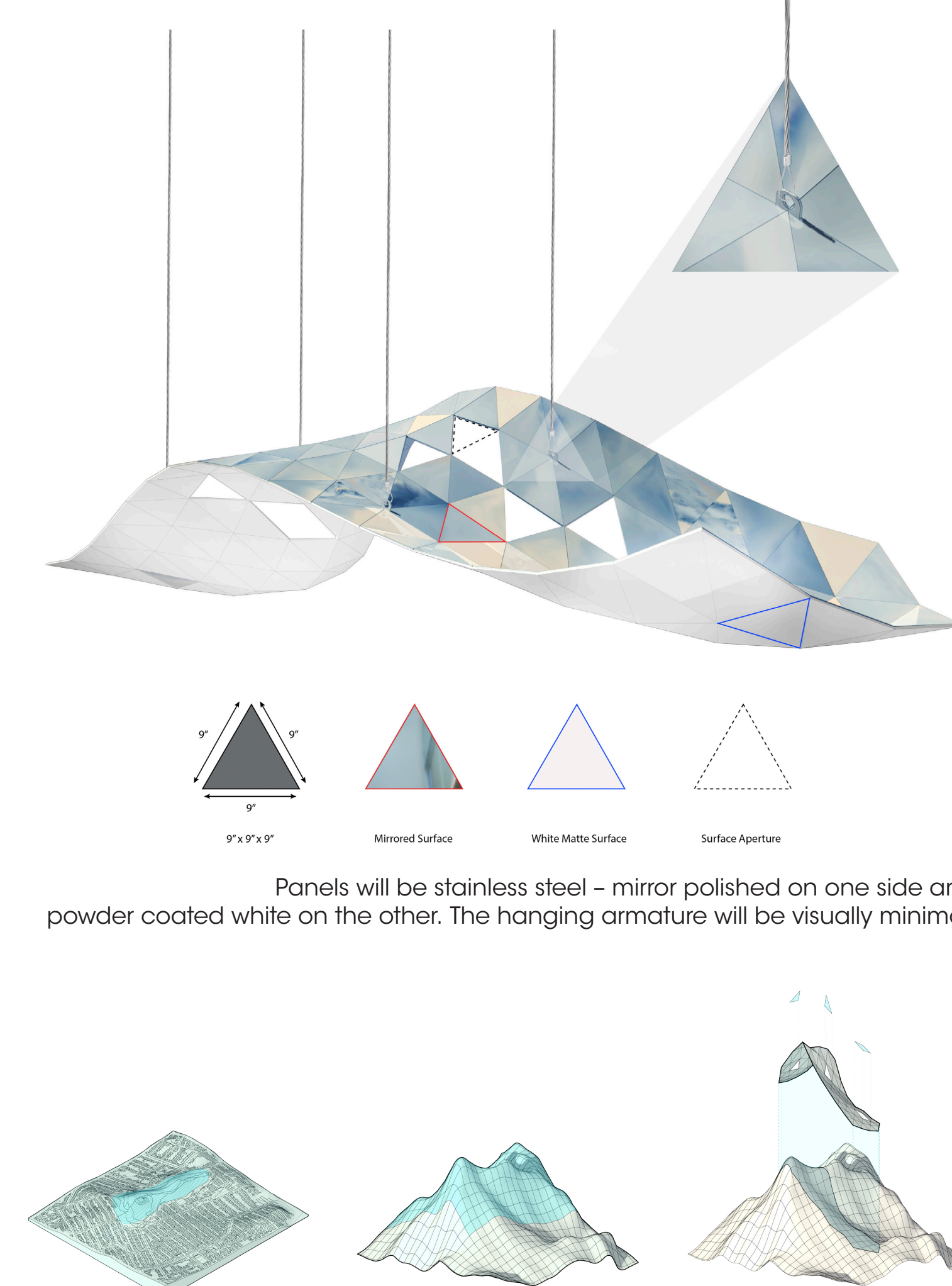

Panels will be stainless steel – mirror polished on one side and powder coated white on the other. The hanging armature will be visually minimal.

Each panel's form references the topographic profile and elevation of a San Francisco neighborhood. Open apertures within the panels reference green space.